



## **PURPOSE**

### **OF UNITED METHODIST WOMEN**

The organized unit of UNITED METHODIST WOMEN shall be a community of women whose PURPOSE is to know God and to experience freedom as whole persons through Jesus Christ; to develop a creative, supportive fellowship; and to expand concepts of mission through participation in the global ministries of the church.



*Join our Conference UMW email list!*  
Sign up on our website, or contact  
Lynne Gilbert (lynnegilbert@bellsouth.net) or  
Janice Lentz( (jlentz@hotmail.com)



## *School of Christian Mission*

*Western North Carolina Conference  
United Methodist Women  
July 16-19, 2009*

*Greensboro College  
815 West Market Street  
Greensboro, North Carolina 27401*

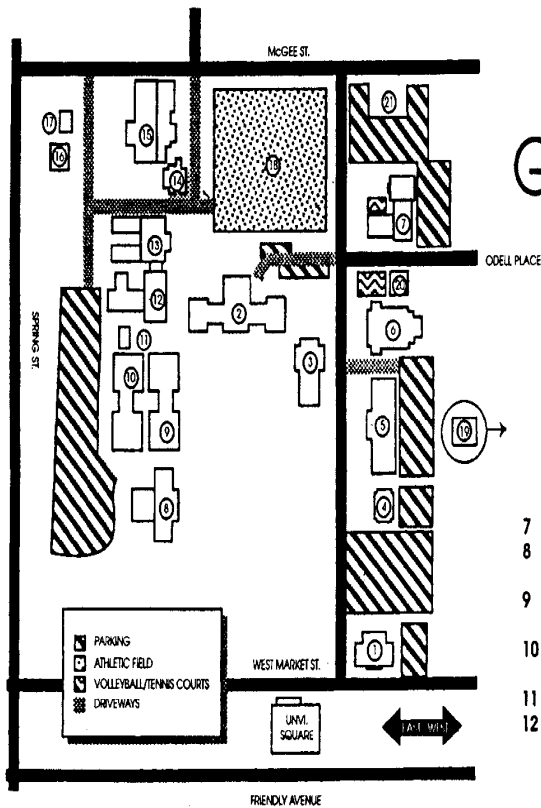

# GREENSBORO COLLEGE MAP

- 1 **Welcome Center**  
Admissions
- 2 **Main Building**  
Administrative Offices  
Anne Sellars Jordan Theatre  
The Brock Historical Museum of Greensboro College  
Lea Center  
Security Office
- 3 **Hannah Brown Finch Memorial Chapel**
- 4 **Adult Education Building**
- 5 **Cowan Humanities Building**  
Classrooms, Faculty Offices  
Irene Cullis Gallery  
Campus Computer Center
- 6 **Odell Memorial Building**  
Classrooms, Faculty Offices  
Gail Brower Huggins Performance Center

- 7 **West Residence Hall**
- 8 **James Addison Jones Library**  
Sternberger Cultural Center
- 9 **Proctor Hall West**  
Classrooms, Faculty Offices
- 10 **Proctor Hall East**  
Classrooms, Faculty Offices and labs
- 11 **Movement Lab**
- 12 **Greensboro Residence Hall**  
Dining Hall  
Alumni Dining Room  
Gold Dining Room  
Student Health Center
- 13 **The Florence and Carl Hill Residence Hall**
- 14 **Student Center**  
Bookstore  
Leadership Development  
Post Office  
The C-Store  
Student Activities  
The Underground
- 15 **James G. Hanes Physical Education Building**  
Athletic Offices  
Pool
- 16 **Physical Plant**
- 17 **Scene Shop**
- 18 **Athletic Field**
- 19 **Campbell Service House**
- 20 **Campbell Career Center**
- 21 **Pride Place**  
Football Program

## Together At The Table

2009 School of Christian Mission Theme

*For generations the table has been an important symbol for the gathered community. It is around the table that food is shared, discussions are held, decisions are made, crafts and board games are played.*

*As Christians, we are reminded of the significance of the table in Jesus' life and ministry.*

*All along his journey, Jesus shared meals in the home of friends, In the temple, he overturned the tables of injustice. One the eve of his death, around the table with his disciples, he broke bread and set forth a means of grace for all who would believe.*

*Yet, when we gather at the table, there are contradictions. At the table, there is feast and there is famine. At the table, treaties are made and treaties are broken. At the table, hospitality is offered and hospitality is denied. At the table, we gather to celebrate and we gather to grieve. At the table, there is peace and there is conflict. At the table, there is hope and there is doubt.*

*Our human frailties and the realities of the world in which we live too often divide and exclude people at our table. The Christ we follow calls us to a higher standard of living and loving as together we work for peace and justice for all creation.*

*As the Psalmist says, "Lord, you have been in our dwelling place in all generations. Before the mountains were brought forth, or ever you had formed the earth and the world, from everlasting to everlasting you are God." (Psalm 90:1-2)*

*Though we are many, we are bound by a living God who goes before us and embraces all. In the sacred circle of life, enfolding the world and all that dwell, therein, all are together at the table of God's love.*



## 2009 SCHOOL COMMITTEE

Michelene Mathews (Chairperson), Karen Wilkerson, Donna Parsons,  
Brenda Alexander, Amy Johnson, Sandy Hieronymus, Ann Aldridge, Sharon  
Smith, Linda Young, Linda Baity, Patricia Wiseman, Kim Keyse,  
Nilla Cody, Velma Zeek

### *Food and Faith*

Rev. Angela Pleasants

Finch Chapel

### **STUDY LEADERS**

#### *The Beauty and Courage of Sudan*

Ms. Martha Phillips	Proctor Hall West 107
Ms. Ruth Daugherty	Proctor Hall West 125
Frederick Jones	Proctor Hall West 223
Ms. Sandra Williamson	Proctor Hall East 204
Rev. Mark Barden	Proctor Hall West 305
Ms. Lynda Morris	Proctor Hall West 316

#### *Giving Our Hearts Away: Native American Survival*

Rev. Donna Strickland-Smith	Proctor Hall West 321
Ms. Darlene Jacobs	Proctor Hall East 114

### *OVERVIEW OF STUDIES*

Ms. Amy Johnson—Food and Faith	Cowan 303
Ms. Lynn Sloan Barnes—Food and Faith	Cowan 301
Ms. Janice Lentz—The Beauty and Courage of Sudan	Cowan Lecture 120
Ms. Linda Baity—The Beauty and Courage of Sudan	Cowan 113

### *WORKSHOP FOR LEADERS OF CHILDREN*

Ms. Sandy Hieronymus Proctor Hall East 106 Friday 4:15 - 5:15 pm

### *TEEN WOMEN MISSION DAY*

Ms. Sherry Sink Saturday, 10:00 am - 4:00 pm  
Sternberger Library-Lower Level

### **MUSIC LEADERS**

Ms. Patricia Gilbert  
Ms. Donna Cooke

### **MEDIA / TECH SPECIALISTS**

Ms. Linda Reep, Ms. Sharon Quate  
Ms. Lynne Gilbert, Ms. Sara Williams

## NOTES



# Looking Forward

## 2010 School of Christian Mission

July 15-18, 2010  
Greensboro College

Spiritual Growth Study	<i>For the Love of God: John's Letters</i>
Geographic Study	<i>Sudan</i>
General Issue Study	<i>Mission and Evangelism</i>

### SPECIAL APPRECIATION TO...

Greensboro College  
 Dr. Craven Williams, President of Greensboro College  
 Terrie Jacobsson, Our Liaison with Greensboro College  
 Greensboro College Student Assistants  
 Study Leaders  
 Music Leaders  
 Dori Thurman & Shirley Hickok  
 Media and Technical Specialists  
 Class Hostesses / Secretaries  
 School Officers and Committee  
 Conference Officers  
 Golf Cart Drivers  
**Statesville District**  
**AND**  
**Especially to all of you who came and  
 participated in the school**

### FOR YOUR INFORMATION

Dean's Office	Hill 115
Lost and Found	Hill 115
College Telephone (8:00 am.- 4:30 pm)	336-272-7102
Campus Security	336-272-7102, Ext. 245
Guilford County Sheriff's Department	Dial 9-1-1 or 336-373-2999
Michelene Mathews' cell phone number	704-649-8612
Karen Wilkerson's cell phone number	828-217-4725
Brenda Alexander's cell phone number	704-502-8067
<b>First Aid Supplies</b>	Hill 115

### NAME TAG DESIGNATIONS

School Officers, Study Leaders, Music Leaders, Media & Technical Specialists, Trainees Hostess District First Timers	<b>Red Bow Multi-Color Bow Stars</b>
---	--

*Please allow persons with bows printed on their name tags to cut into the  
meal line in order to carry out their responsibilities.*

### OTHER ANNOUNCEMENTS

- ◆ There will be a \$25.00 charge for unreturned keys and a \$10.00 charge for unreturned scan cards. Return keys/scan cards (in envelope) to college staff when you leave on Sunday. If leaving early, turn them in to the Dean's office.
- ◆ Friday night's dinner will be a District Get-Together. You are encouraged to eat with members of your district to get to know one another better.
- ◆ Continuing Education Unit (CEU) forms are available from class secretaries or from the Dean's Office.
- ◆ In addition to the Program Resources room, study materials for the Mission Studies are available in Cowan Lobby during registration on Friday and Saturday.
- ◆ For resident students, trash bags should be set outside of your room when you leave on Sunday. Rented linens should be put inside pillowcase and left outside of your room. ***Please leave the room unlocked and turn off the air conditioner.***

## DAILY SCHEDULE

### THURSDAY, JULY 16

1:30 - 5:00 pm	Discovery Room	Alumni Room, Greensboro Hall
	Resource Room	Gold Room, Greensboro Hall
2:00 - 5:00 pm	Registration	Main Building, Lea Center
2:00 - 5:00 pm	Reception	Main Building, Lea Center
	<i>Hostess District: Statesville District</i>	
5:30 pm	Dinner	Dining Hall
6:30 - 7:30 pm	Singing / Announcements / Introductions	Finch Chapel
7:30 - 9:00 pm	Food and Faith (Session I)	Finch Chapel

### FRIDAY, JULY 17

6:45 am	Morning Praise	Front Steps, Hill Dorm
7:00 am	Breakfast	Dining Hall
7:30 - 8:00 am	Discovery Room	Alumni Room, Greensboro Hall
	Resource Room	Gold Room, Greensboro Hall
8:00 - 10:00 am	Registration	Cowan Lobby
8:15 - 9:00 am	Singing / Announcements	Finch Chapel
9:00 - 10:30 am	Food and Faith (Session II)	Finch Chapel
10:45 - 12:00	The Study of Sudan (Session I)	Classrooms
10:45 - 12:00	Giving Our Hearts Away (Session I)	Classrooms
10:00 - 12:00	One Day Overview Classes	Classrooms
12:00 Noon	Lunch	Dining Hall
12:30 - 1:45 pm	Discovery Room	Alumni Room, Greensboro Hall
	Resource Room	Gold Room, Greensboro Hall
2:00 - 4:00 pm	One Day Overview Classes	Classrooms
2:00 - 4:00 pm	Full-time Classes (Session II)	Classrooms
4:15 - 5:15 pm	Workshop for Leaders of Children	Proctor Hall West 321
5:30 pm	Dinner	Dining Hall
6:00 - 6:15 pm	Discovery Room	Alumni Room, Greensboro Hall
	Resource Room	Gold Room, Greensboro Hall
6:30 - 7:30 pm	Singing / Announcements	Finch Chapel
7:30 - 9:00 pm	Food and Faith (Session III)	Finch Chapel
9:15 pm	Executive Committee Meeting	Greensboro Hall Lounge

## WHERE TO FIND IT

**Resource Room - Gold Room - Greensboro Residence Hall**  
**Discovery Room - Alumni Room - Greensboro Residence Hall**  
*Schedule of Discovery Room and Program Resources:*

*Thursday*      1:30 - 5:00 pm  
*Friday*        7:30 - 8:00 am, 12:30 - 1:45 pm, & 6:30 - 6:45 pm  
*Saturday*      7:30 - 8:00 am & 12:30 - 1:45 pm

\* \* \* \* \*



## Annual Meeting September 11, 12, & 13, 2009 Lake Junaluska

Worship, Fellowship,  
 Excellent Speakers,  
 the Processional of  
 Missionaries, *Late Night*,  
 Learning Opportunities, and  
 MORE!

**Come for it All or  
 Come for a Day...Just Come!  
 And, Bring a Friend!**

## LIST OF BASIC RESOURCES 2009 SCHOOL OF CHRISTIAN MISSION

### SPIRITUAL GROWTH STUDY *Food and Faith*

*Food and Faith*: Adult text written by Wendy Whiteside; Study Guide by Faye Wilson (Stock #M3030-2009-01) *Food, Faith, and Me: Youth Spiritual Growth Study*”

### GEOGRAPHIC STUDY *The Beauty and Courage of Sudan Why a Dream of Peace is Possible*

*The Beauty and Courage of Sudan*: Adult Study by Linda Beher; Study Guide by Maxine West (Stock #M3060-2009-01); *Response Magazine* April 2009, *New World Outlook* May/June 2009.

### GENERAL ISSUE STUDY *Giving Our Hearts Away: Native American Survival*

*Giving Our Hearts Away: Native American Survival*: Adult Text by Thom White Wolf Fassett; Study Guide by Brenda Connelly (Stock #M3105); *Response Magazine* April 2008; *New World Outlook Magazine* July/August 2007 & May/June 2008; DVD: *Stories from the Circle of Life* (Stock #M3106); *Walking in These White Man Shoes: Youth Explore Native America* (Stock #M3022); *Creator Sang a Welcoming Song: Native America for Children* (Stock #M3021)

### TO ORDER RESOURCES FOR YOUR LOCAL UNIT, CONTACT:

**The Mission Resource Center**  
1221 Profit Drive, Dallas, TX 75247  
Call toll free: 1-800-305-9857  
FAX: 1-214-630-0079  
[www.missionresourcecenter.org](http://www.missionresourcecenter.org)

## DAILY SCHEDULE

### SATURDAY, JULY 18

6:45 am	Morning Praise	Front Steps, Hill Dorm
7:00 am	Breakfast	Dining Hall
7:30 - 8:00 am	Discovery Room	Alumni Room, Greensboro Hall
	Resource Room	Gold Room, Greensboro Hall
8:00 - 10:00 am	Registration	Cowan Lobby
8:15 - 9:00 am	Singing / Announcements	Finch Chapel
9:00 - 10:30 am	Food and Faith (Session IV)	Finch Chapel
10:00 - 4:00 pm	Teen Women Mission Day	Cowan Upper Lobby
10:45 - 12:00	The Study of Sudan (Session III)	Classrooms
10:45 - 12:00	Giving Our Hearts Away (Session III)	Classrooms
10:00 - 12:00	One Day Overview Classes	Classrooms
12:00 Noon	Lunch	Dining Hall
12:30 - 1:45 pm	Discovery Room	Alumni Room, Greensboro Hall
	Resource Room	Gold Room, Greensboro Hall
2:00 - 4:00 pm	One Day Overview Classes	Classrooms
2:00 - 4:00 pm	Full-time Classes (Session IV)	Classrooms
5:30 pm	Dinner	Dining Hall
6:30 - 7:00 pm	Singing / Announcements	Finch Chapel
7:00 - 8:15 pm	Plenary – The Beauty and Courage of Sudan: Why a Dream of Peace is Possible	Finch Chapel
8:30 pm	Study Leaders/School Comm. Evaluations	Gold Room
8:30 pm	Fellowship Time	Hill Ground Lounge

### SUNDAY, JULY 19

6:45 am	Morning Praise	Front Steps, Hill Dorm
7:00 am	Breakfast	Dining Hall
8:30 - 9:45 am	Full-time Classes (Session V)	Classrooms
9:45 - 10:00 am	Break	
10:00 - 11:00 am	Full-time Classes (Session VI)	Classrooms
11:15 - 11:30 am	Singing / Announcements	Finch Chapel
11:30 - 12:15 pm	Sending Forth	Finch Chapel
12:15 pm	Lunch	Dining Hall

*Depart in Peace*